

86TH AND HAVERSTICK

INDIANAPOLIS, INDIANA

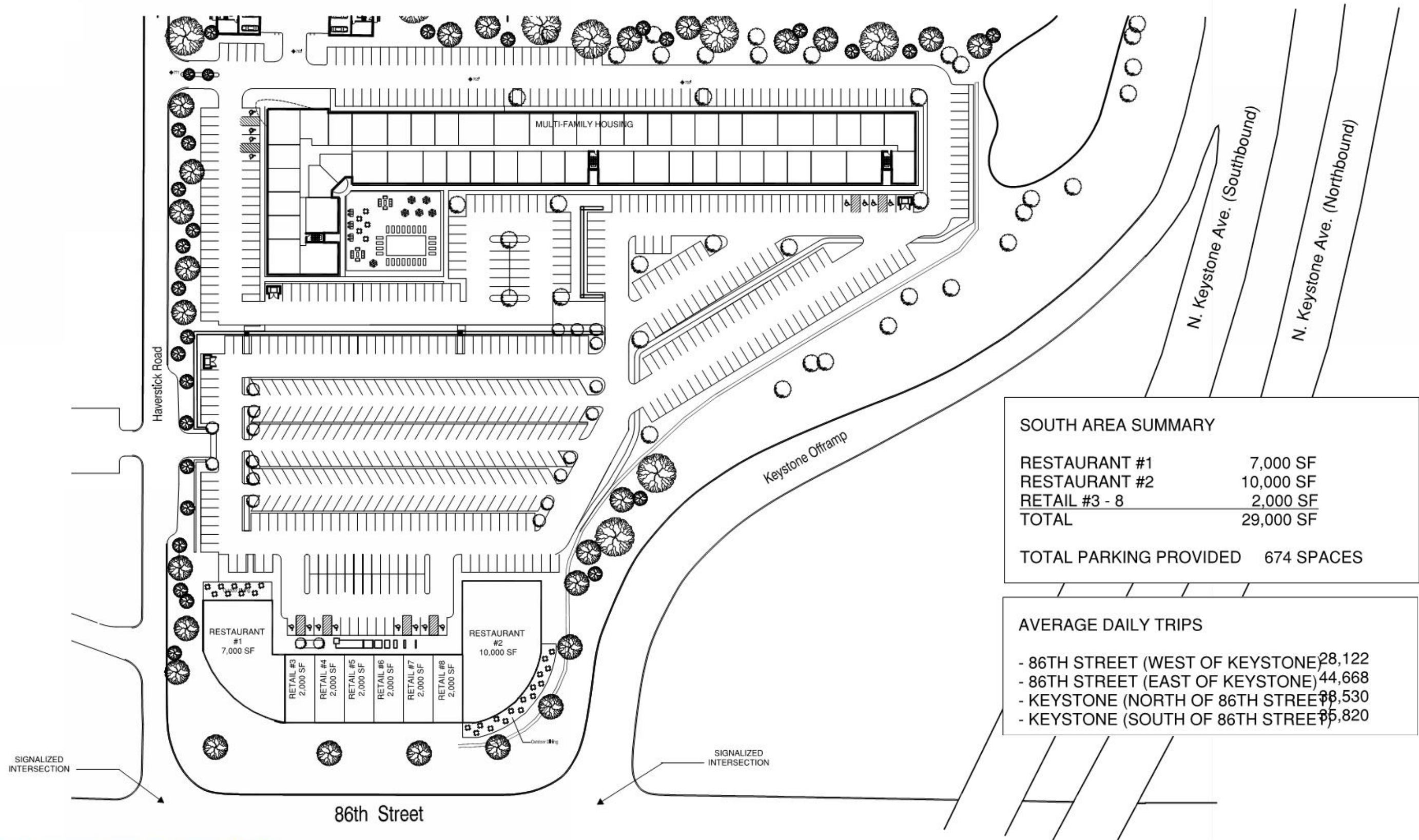

SOUTH AREA SUMMARY	
RESTAURANT #1	7,000 SF
RESTAURANT #2	10,000 SF
RETAIL #3 - 8	2,000 SF
TOTAL	29,000 SF
TOTAL PARKING PROVIDED 674 SPACES	

AVERAGE DAILY TRIPS	
- 86TH STREET (WEST OF KEYSTONE)	28,122
- 86TH STREET (EAST OF KEYSTONE)	44,668
- KEYSTONE (NORTH OF 86TH STREET)	38,530
- KEYSTONE (SOUTH OF 86TH STREET)	35,820